

TECH PACK

ROCKET Mortgage
FIELDHOUSE



ROCKET Mortgage
FIELDHOUSE

STORAGE

FIELDHOUSE

CLE

WELCOME TO
ROCKET Mortgage
FIELDHOUSE

Rocket Mortgage FieldHouse (formerly Quicken Loans Arena) is a state-of-the art facility located in Cleveland, Ohio and is home to the NBA Cleveland Cavaliers, AHL Cleveland Monsters, signature sporting events, concerts, and family entertainment shows.

Rocket Mortgage FieldHouse recently completed a two-year renovation project that has dramatically transformed the venue into a modernized world-class sports and entertainment showplace for the entire Northeast Ohio region.

The massive \$185 million renovation includes major upgrades and has expanded the facility's public space by over 57,000 square feet. The "all new" Rocket Mortgage FieldHouse now features wider concourses, several new hospitality and meeting spaces and the latest cutting-edge technology that re-defines the fan experience.

The underground service area, for quick, convenient load-in and load-out, is among the venue's many assets that are second-to-none in both technology and amenities that exceed production needs and requirements.

To ensure the success of your event, Rocket Mortgage FieldHouse offers a dedicated team of professionals that specialize in all areas of event planning, hospitality, customer service, production and building operations that are considered to be among the best in the business. We look forward to welcoming you into our home.

The remainder of this packet expands on the first-class amenities of our venue and provides detailed technical specifications. However, if you have any questions or would like to discuss hosting your event at Rocket Mortgage FieldHouse, please reach out to a member of our team.

Sincerely,



Antony Bonavita, CVE
Executive Vice President of Venue Operations



Matthew Miller
Vice President of Operations



Brooke Bockelman
Vice President of Booking

TABLE OF CONTENTS

- 01** Rocket Mortgage FieldHouse Contacts
- 02** Directions & Parking
- 05** Catwalk, Curtain, & Spotlight
- 06** Stage Setup
- 08** Stage Rigging
- 09** Event Level Layout
- 12** LED Content Creation
- 14** Technical Information
- 15** Show Power
- 18** Security Policies
- 19** Hospitality, Banquet & VIP Spaces

EVP, Venue and Facility Operations	Antony Bonavita	abonavita@cavs.com	(216) 420-2021
VP, Facility Operations	Matt Miller	mmiller@cavs.com	(216) 420-2022
VP, Event Booking	Brooke Bockelman	bbockelman@cavs.com	(216) 420-2251
Senior Director, Safety and Security	Brian Herbert	bherbert@cavs.com	(216) 420-2199
Senior Manager, Event Services	Dominic Pavone	dpavone@cavs.com	(216) 420-2261
Coordinator, Events	Raymond Caraballo	rcaraballo@cavs.com	(216) 420-2378
Director, Event & Arena Marketing	Carrie Samek	csamek@cavs.com	(216) 420-2591
Manager Private Events/Banquets Booking	Shari Lindenbaum	slindenbaum@cavs.com	(216) 420-2157
Manager, Retail Operations	Cate Crouch	ccrouch@cavs.com	(216) 420-2044
General Manager, ARAMARK	Adam Zann	zann-adam@aramark.com	(216) 420-2659
Director, Premium Catering	Laura Caler	caler-laura@aramark.com	(216) 420-2618

OVERFLOW CONCERT AND EVENT PARKING

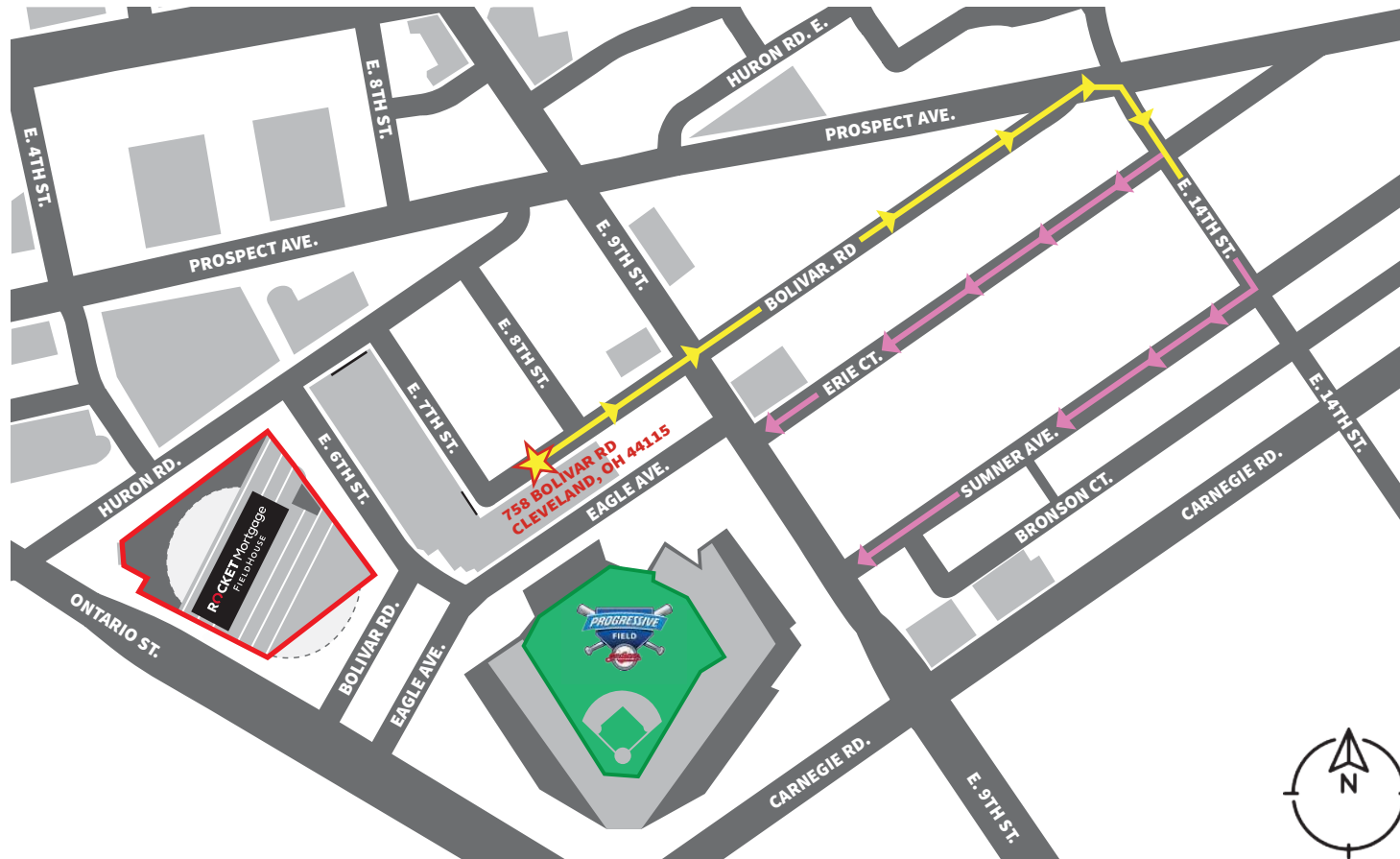

On-site Parking / Dock Address

758 Bolivar Road, Cleveland, OH 44115

- Overflow Parking on Erie Ct. and Sumner Ave. (Permit Required)
- Parking on both sides of the street is allowed
- Please do not block driveways
- ★ Underground entrance to Truck/Bus parking

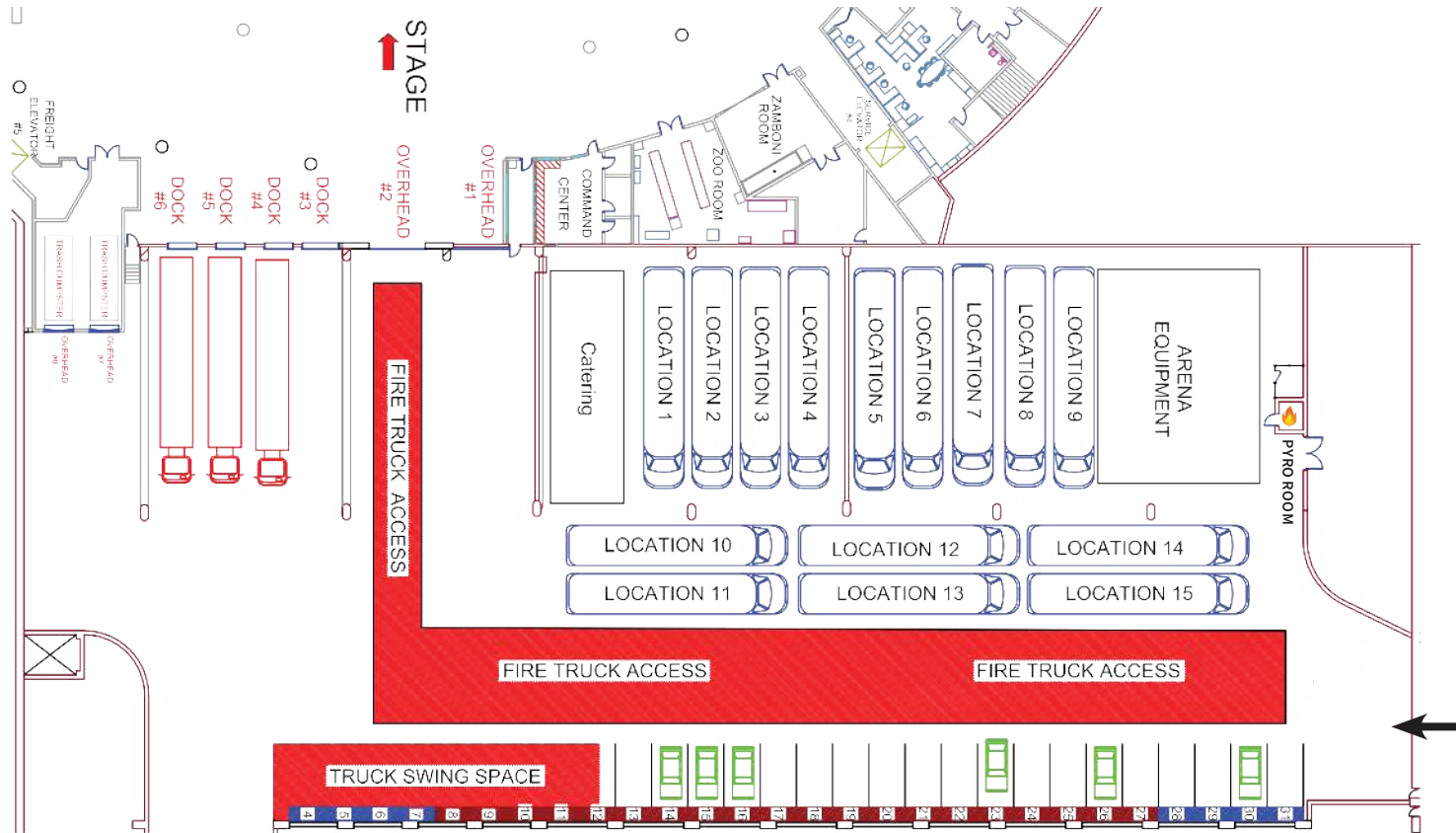

ONSITE PARKING & DOCK

FROM THE EAST:

Interstate 90/Rt. 2 West. Follow signs to Downtown Cleveland. Remain on Rt. 2 as I-90 curves away to the left. Exit at E. 9th St.; Turn left on E. 9th St.; South to Rocket Mortgage FieldHouse parking.

FROM THE SOUTH:

I-77 North. Exit at Woodland Ave.; toward E. 30th St.; keep left. Follow signs for Woodland Ave/Gateway/E. 30th St.; slight left onto OH 8 N./Woodland Ave. Turn right onto Huron Rd.

FROM THE WEST:

I-90 East. Exit at E. 9th St.; continue straight and Rocket Mortgage FieldHouse will be on your left-hand side.

FROM THE SOUTHWEST:

I-90 East or I-71 North to the Inner Belt merge. Continue on Inner Belt (I-90) to 9th St.; exit onto E. 9th St.; continue straight and Rocket Mortgage FieldHouse will be on your left-hand side.

FROM CLEVELAND HOPKINS AIRPORT:

I-71 North. Continue onto I-90 East. Exit onto E. 9th St.; continue straight and Rocket Mortgage FieldHouse will be on your left-hand side.

UNDERGROUND TRUCK/BUS PARKING ENTRANCE:

Enter Bolivar Rd. from E. 9th St.; the entrance will be on the left. Please have a photo ID available.

SHOW OVERFLOW PARKING

To access overflow parking, proceed down Bolivar Road to East 14th Street. Make a right on East 14th Street until you see Erie Court or Sumner Avenue. Make a right turn on Erie Court or Sumner Avenue. Parking is available on both sides of the street. Please do not block any driveway aprons, and display permits in driver's side window. For a permit, please contact the Senior Manager, Event Services (Dominic Pavone) at dpavone@cavs.com.

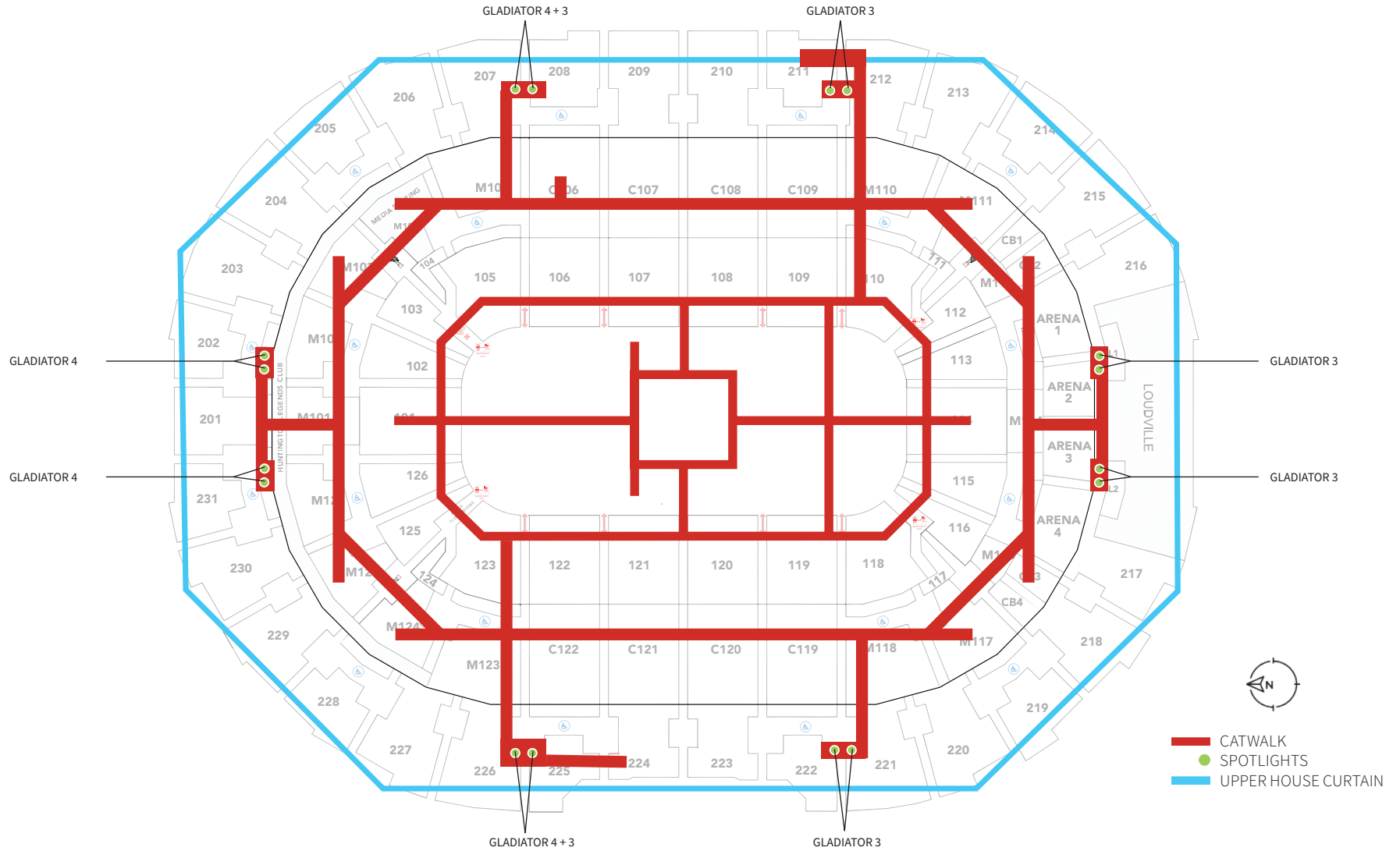

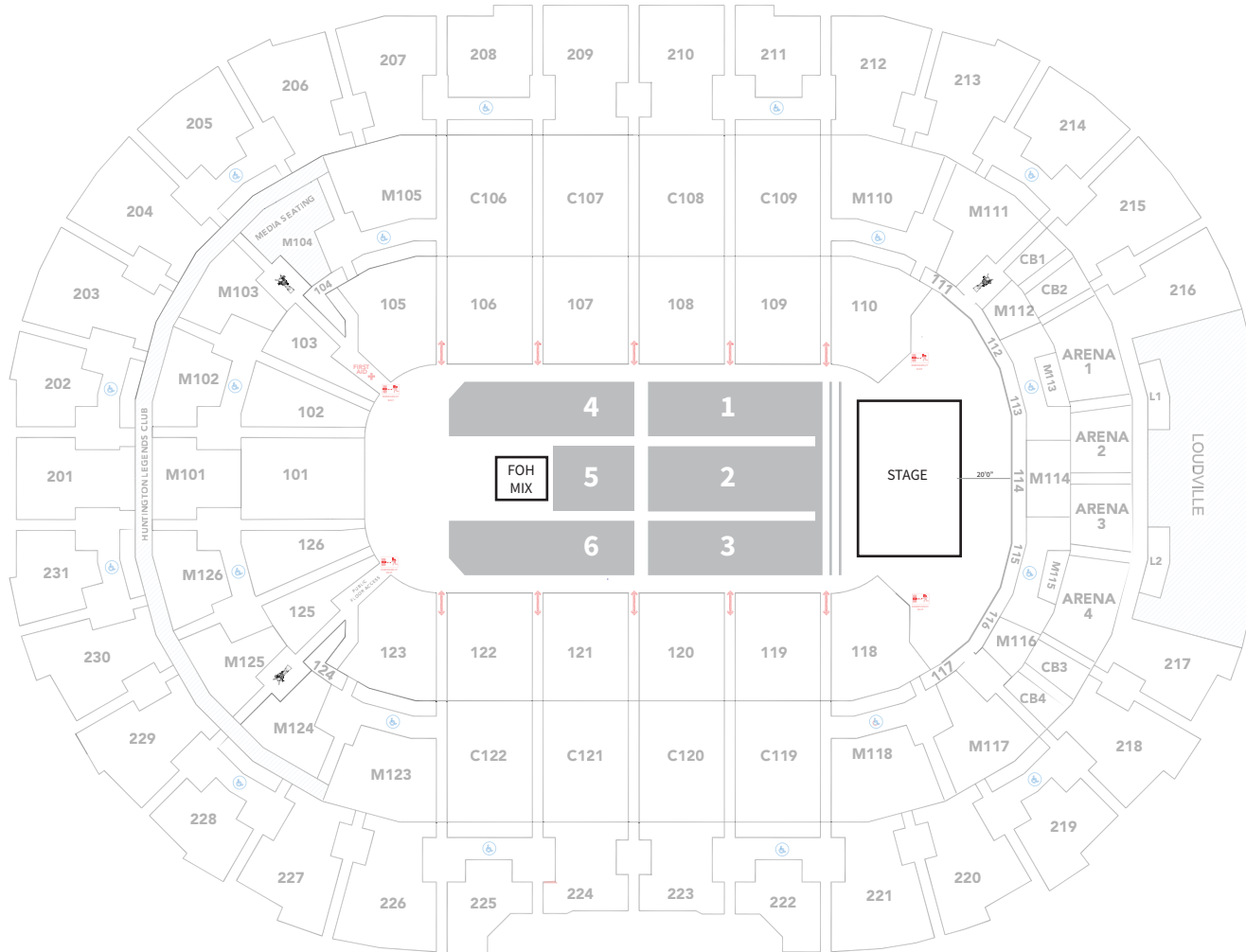

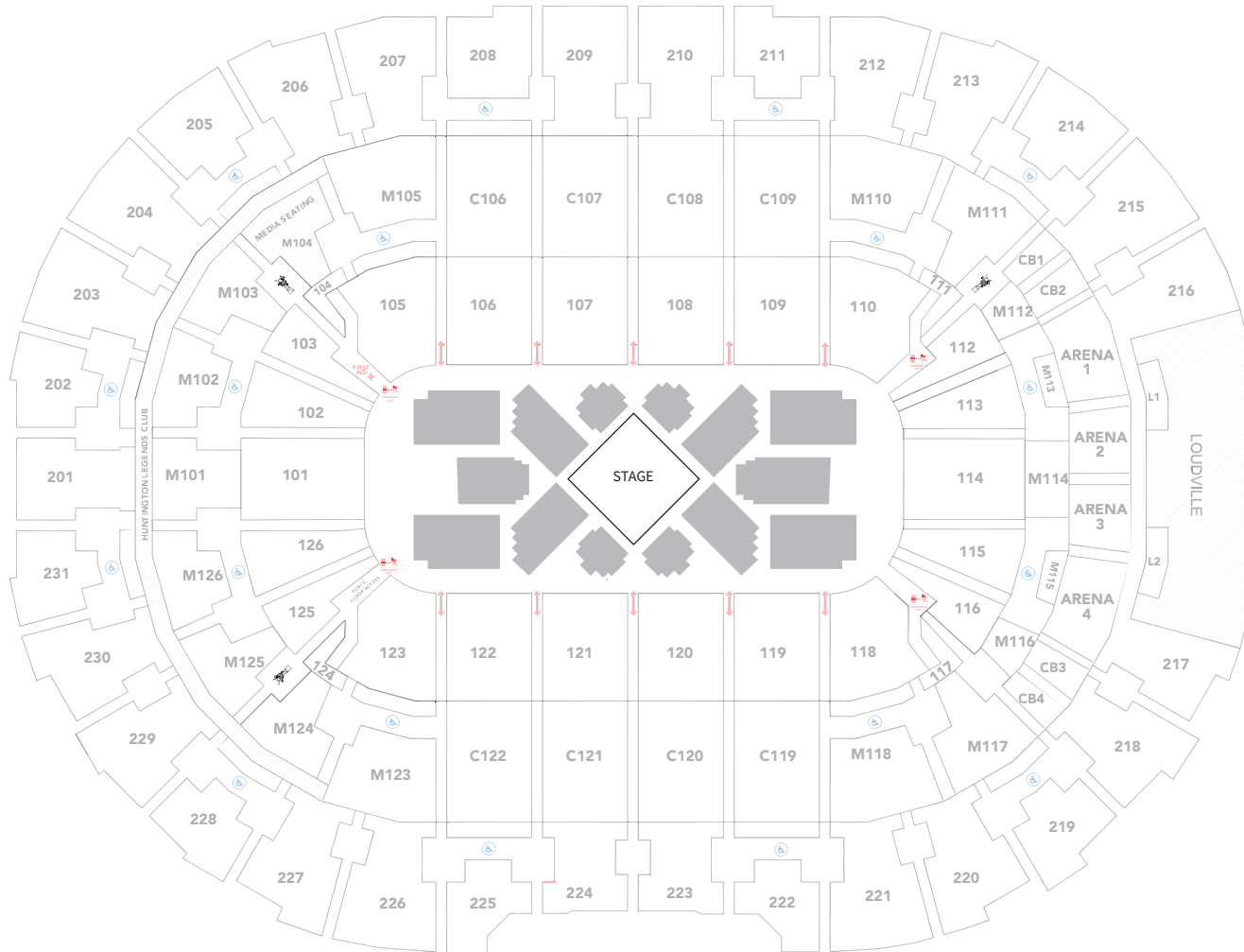

DRESSING ROOM INVENTORY

DRESSING/LOCKER ROOM	SQUARE FOOTAGE	BATHROOM	DESCRIPTION
A	273	COMMUNITY (8 Showers)	Community lockers and can be subdivided
B	360	COMMUNITY (8 Showers)	Community lockers and can be subdivided
C	321	PRIVATE	Separate dressing room; and floor length mirror
D	294	PRIVATE	Separate dressing room, can be combined with F into one room, and floor length mirror
E	465	COMMUNITY (8 Showers)	Community lockers, separate coach's, and floor length mirror
F	320	PRIVATE	Separate dressing room, can be combined with D into one room, and floor length mirror
G	252	PRIVATE	Separate dressing room and floor length mirror
H	507	COMMUNITY (8 Showers)	Community lockers and separate coach's office
I	264	PRIVATE	Separate dressing room and floor length mirror
GREEN ROOM	338	PRIVATE	Separate dressing room, mini-kitchen and floor length mirror

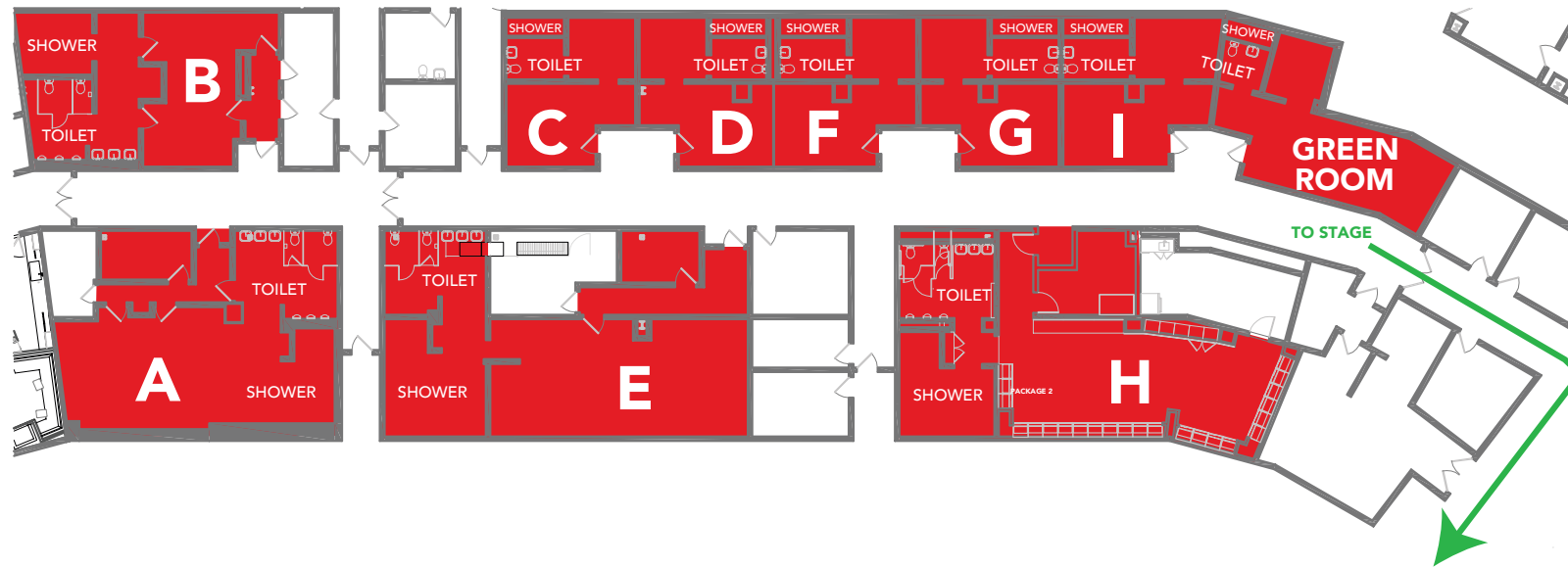



C. LOWER RIBBON (2)
CONTENT CREATION SPECIFICATIONS

All content must be designed at 4416px wide by 40px high.

Pixel aspect ration is 1:1 square pixels.

Use RGB color mode when designing.

*NOTE: There are 2 STAT display areas. Do NOT place partial messages, text or logos over these breaks.

PREFERRED DELIVERY FORMATS

STILLS: PNG, Millions of Colors

ANIMATIONS: Quicktime animation codec or AVI
Uncompressed format, 30fps, Millions of Colors

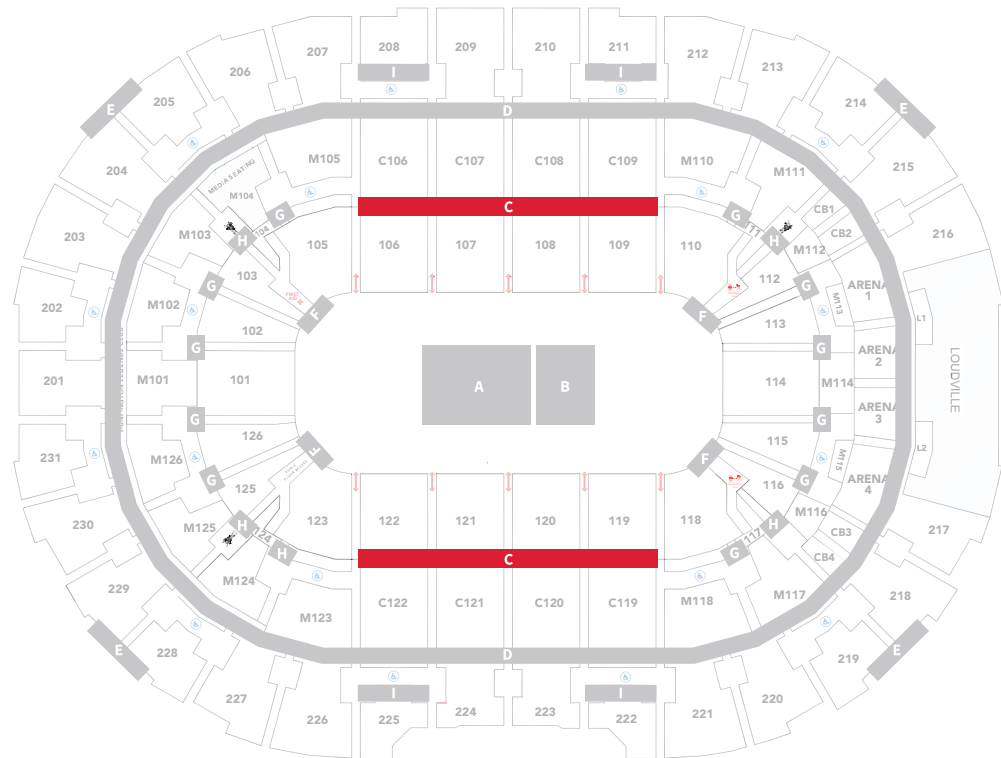

4416 x 40 PIXELS

**D. UPPER RIBBON
CONTENT CREATION SPECIFICATIONS**

All content must be designed at 20208px wide by 40px high.

Pixel aspect ration is 1:1 square pixels.

Use RBG color mode when designing.

PREFERRED DELIVERY FORMATS

STILLS: PNG, Millions of Colors

ANIMATIONS: Quicktime animation codec or AVI
Uncompressed format, 30fps, Millions of Colors

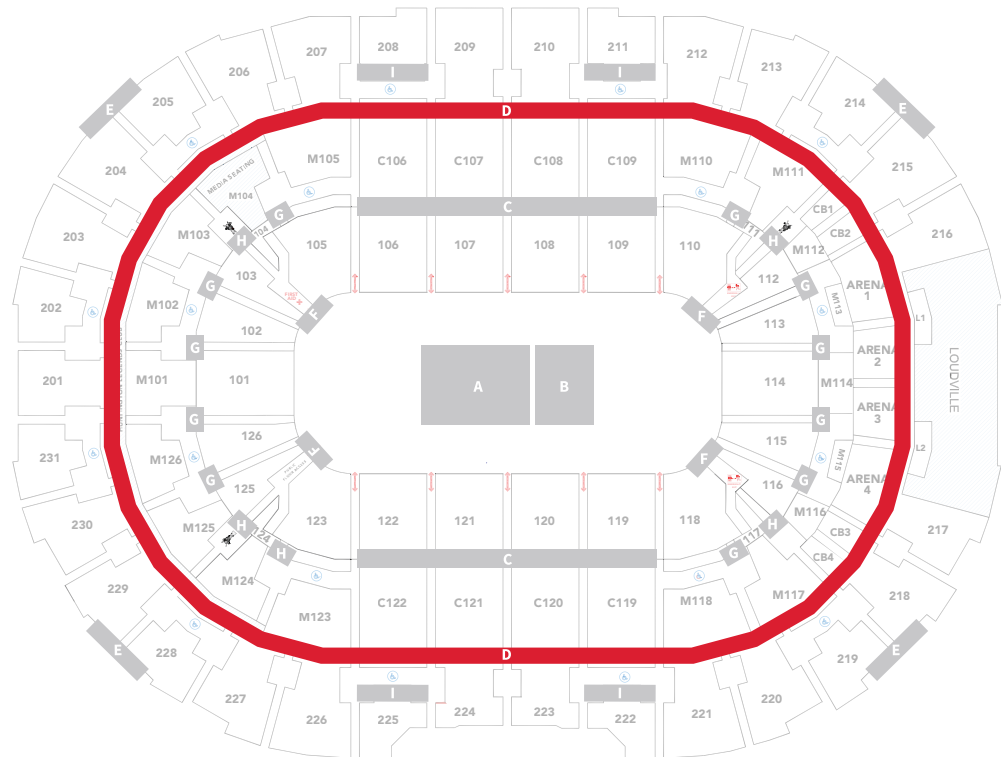

20208 x 40 PIXELS

SCOREBOARD/VIDEO CAPABILITIES

The “Humongotron”, a 5,500 square foot scoreboard with 4 HD video screens, makes our scoreboard the largest HD board in any arena in the country. The four-sided, center-hung scoreboard has four enormous HD video screens that are tilted and uniquely curved to provide optimal viewing angles for all fans whether they seated in the front row on the floor, or in the upper level (in Loudville). The two sideline screens measure 31.5’ high x 56.69’ wide and feature greater-than-HD video. The two high-resolution baseline screens measure 29.92’ high x 33.07’ wide.

In addition to the new scoreboard, Rocket Mortgage FieldHouse will be illuminated with a grand total of more than 11,862 square feet of new LED displays that have been installed in the arena’s seating bowl and concourses. This included updating the four corner boards and 360-degree fascia ribbon in the seating area and replacing traditional backlit signage on the concourses with high resolution LED technology. Five hundred and sixty-two (562) television monitors are located throughout the arena so guests do not miss a minute of entertainment during visits to the concours areas. Rocket Mortgage FieldHouse offers a full-service production facility. The newly renovated video production control room will feature a 6 ME Grass Valley video switcher, five cameras, including two wireless cameras for crowd interaction and contests, two Dyno six channel replay units, including super-slow options, and four scoreboard mounted robotic cameras to capture unique views of game action and additional crowd shots.

SOUND SYSTEM

Rocket Mortgage FieldHouse’s concert quality sounds system is configured in a 6-array system. Each array is comprised of 10 JBL VLA-901 with 4 additional ASB-7128 subwoofers. The arrays are configured with one array towards each end zone and two arrays along each side. These arrays are height adjustable for either storage above or optimized listening level. Additional speakers (10 JBL AM5212/95) are in the scoreboard for near fill and floor fill. The array systems are powered by 32 Crown HD 4x3500 and 12 Crown I-tech 12000. These provide over 200,000 watts of incredible sound inside the seating bowl. All processing is via BSS sound web & a Yamaha M-7 is supplied for mixing. Ceiling speakers are supplied throughout all concourses, suite hallways, restrooms and dressing rooms. Furthermore, audio lines run to every area of the fieldhouse, providing over 120 locations for mic and speaker hook ups. In addition, a Telex Hearing impaired system is available.

SHOW POWER - SOUTH END

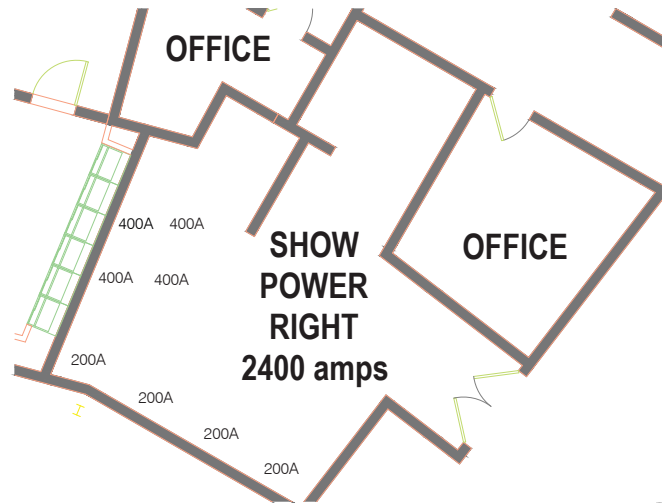
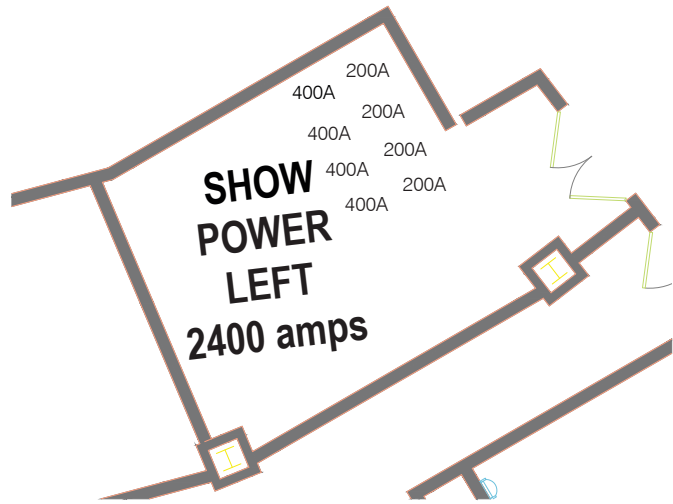

SHOW POWER - DOWN STAGE

- 4 - 400 amp panels - show power left
- 4 - 200 amp panels - show power left
- 4 - 400 amp panels - show power right
- 4 - 200 amp panels - show power right
- All amp panels are 3 phase 208V

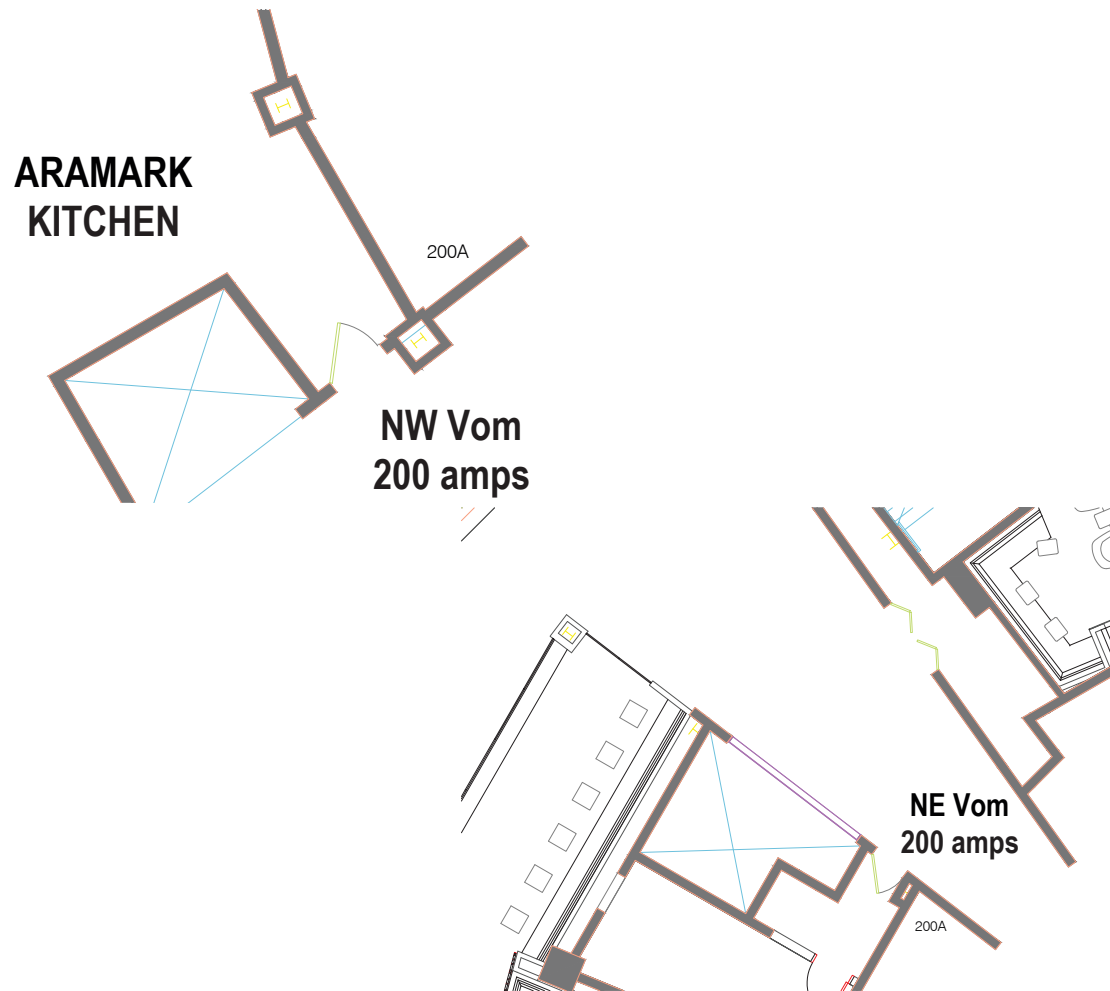

SHOW POWER - DOWN STAGE

- 1 - 200 amp panels - NE VOM
- 1 - 200 amp panel - NW VOM
- All amp panels are 3 phase 208V

We strive to create a safe and secure environment for all of our guests and team members (employees). Safety is our highest priority at Rocket Mortgage FieldHouse. It is our responsibility to make sure all that visit and work in the FieldHouse are safe and secure. We utilize on site security resources as well as work with local, state and federal law enforcement, fire, medical, and public safety officials to maintain an environment where our guests are relaxed to enjoy all events. FieldHouse security personnel reserve the right to determine the method of security checks as deemed necessary including the use of metal detectors of a person, the search of personal hand bags, clothing, and carry items.

What you are not permitted to carry into Rocket Mortgage FieldHouse:

- No video recorders, audio recorders, or other similar electronic devices
- No professional photography
- No laser pointers or weapons of any kind
- No backpacks, large bags, sealed packages of any kind (including gifts for performers)
- No flag poles / flags that obstruct guest views
- No bottles, cans, coolers
- No selfie sticks
- No outside food or beverages. Exceptions are made for medical reasons, baby food and reasonable children's snacks (crackers, raisins, juice boxes, etc.)

For a more extensive list please visit <https://www.rocketmortgagefieldhouse.com/>

What you are permitted to carry into Rocket Mortgage FieldHouse:

- Purses, hand bags, and diaper bags are permitted and will be inspected by security
 - Binoculars and cell phones* are permitted and subject to security inspection
- *unless "usage" of a cell phone inside the seating area is directed by a show or promoter to be a prohibited activity*

ROCKET Mortgage
FIELDHOUSE

HOSPITALITY, BANQUET AND VIP SPACES



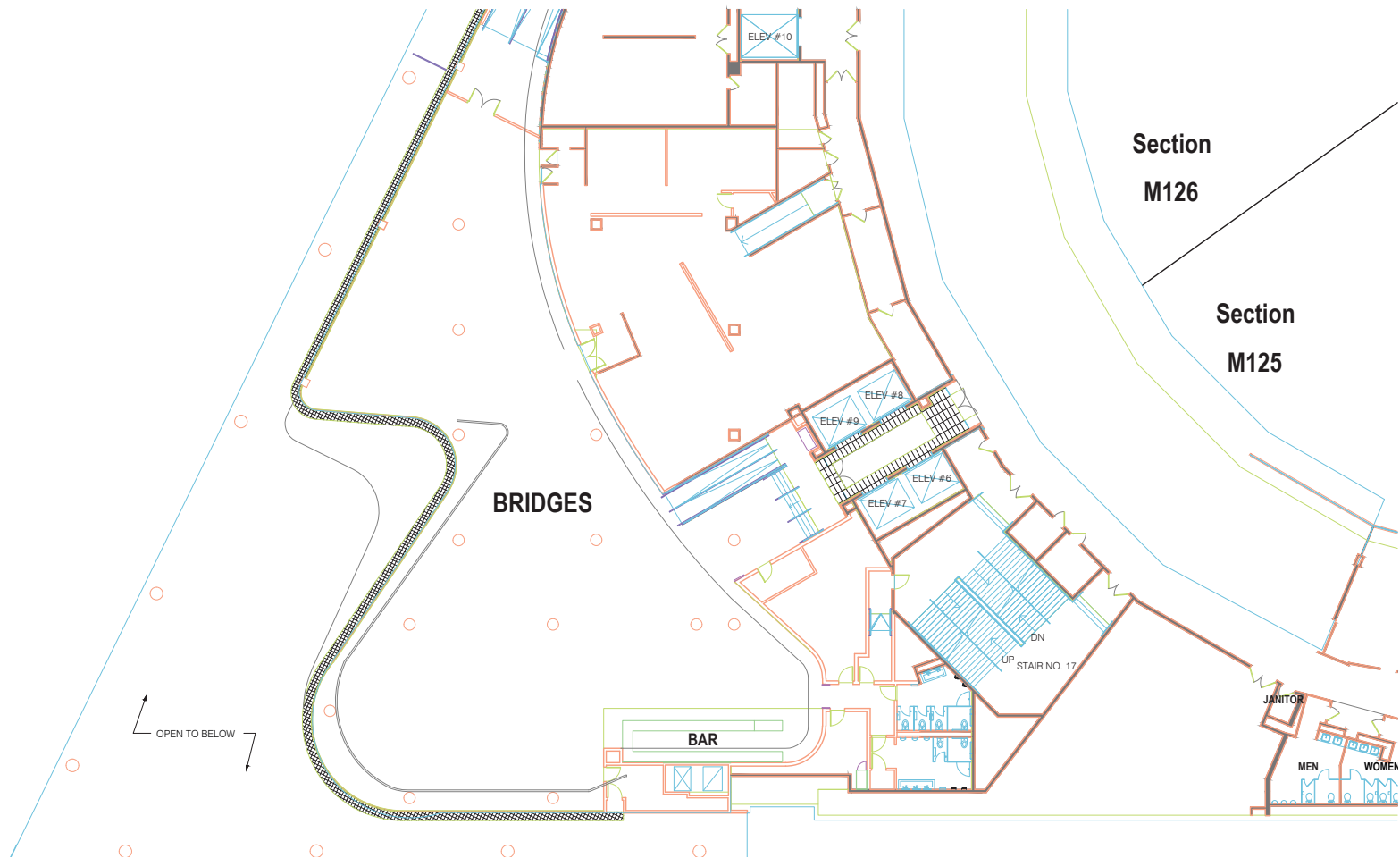



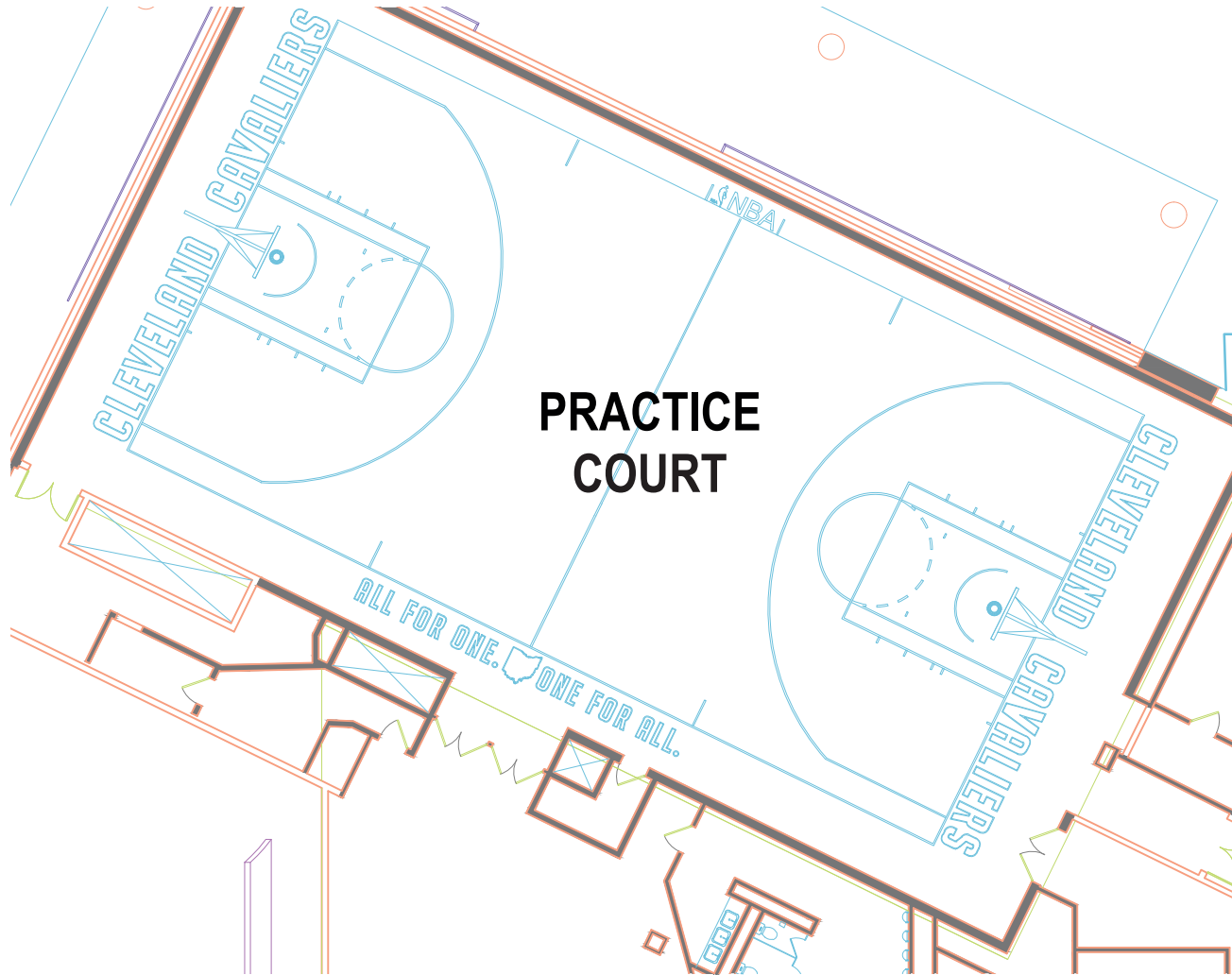



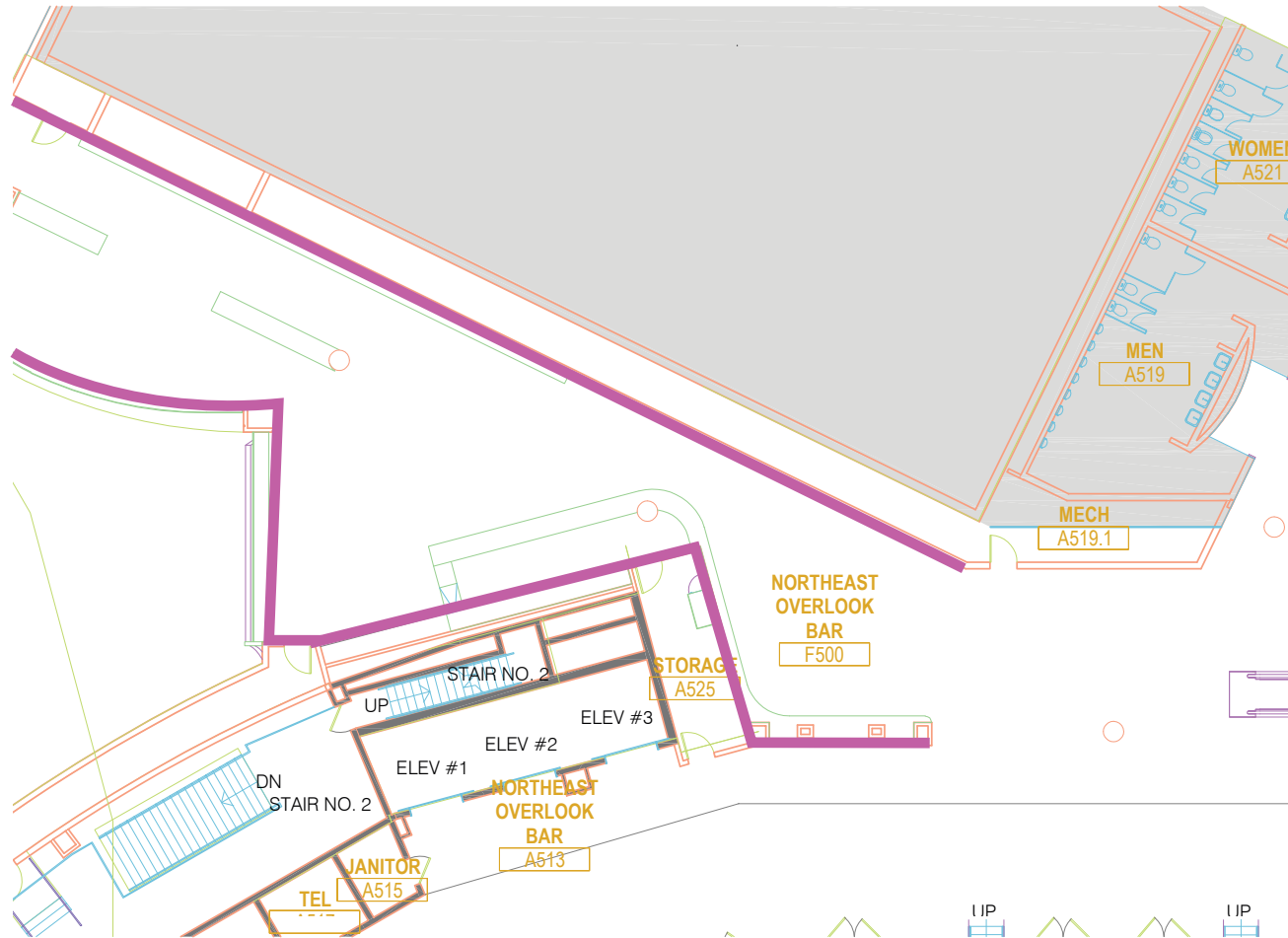

Occupancy: 75





ROCKET Mortgage
FIELDHOUSE